

CABIN AIR FILTER – INSTALLATION INSTRUCTIONS

Part No.: PC5837X Est. Installation Time: less than 15 mins

GM OE: 13175553

The Cabin air filter is located behind the glove compartment

- Remove the glove compartment.
- Remove the 4 bolts (1) **{fig 1}**
- Disconnect the wiring harness plug. **{fig 1}**
- Remove the inner paneling on the instrument panel padding, lower passenger side.
- Remove the 2 bolts (3). **{fig 1}**
- Remove the passenger side footwell air duct. **{fig 1}**
- Remove the body-bound Fastener (2). **{fig 1}**
- Remove the 3 bolts (2). **{fig 2}**
- Remove the access panel for the passenger compartment air filter and remove the air filter (1) in the direction of the arrow. **{fig 2}**
- Remove the 3 bolts (2).
- Insert new filter into filter housing, making sure the air flow direction is correct according to the arrow indicator.
- Replace removed parts by reversing the removal procedure.

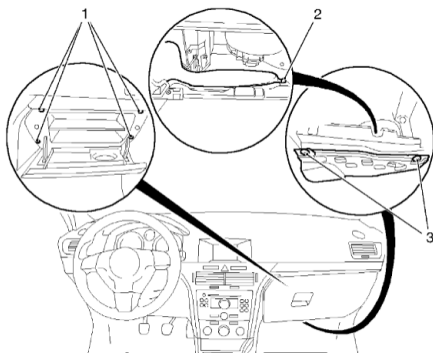

Fig 1

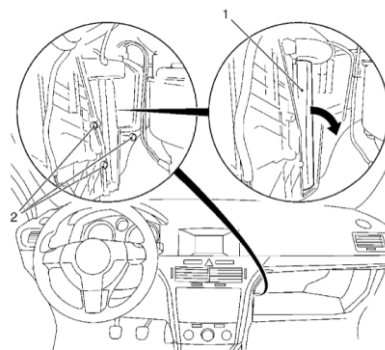

Fig 2

This is only a guide and may not be for exact model. See Owner's manual and/or local mechanic for exact instructions for the particular model.