

CABIN AIR FILTER – INSTALLATION INSTRUCTIONS

Part No.: PC5675X

Est. Installation Time: less than 15 mins

Hyundai – Sonata (00-03), XG300 (01), XG350 (02-03)

The Cabin air filter is located behind the glove compartment

- Disengage the glove box bumpers by pulling them and pivoting them outwards
- Disconnect the cable on the side of the glove box
- Allow glove box to swing down on its hinges
- Remove the bolts and screws holding the back panel of the glove box in place.
- Remove the vertical filter access door by unlatching the bottom of the door and pulling it out
- Remove the old filter from assembly, taking note the air flow arrow indicator on the side of the old filter
- Insert the new filter into the assembly, making sure the air flow direction is correct according to the arrow indicator
- Replace the rest of the glove box assembly by reversing the removal procedure

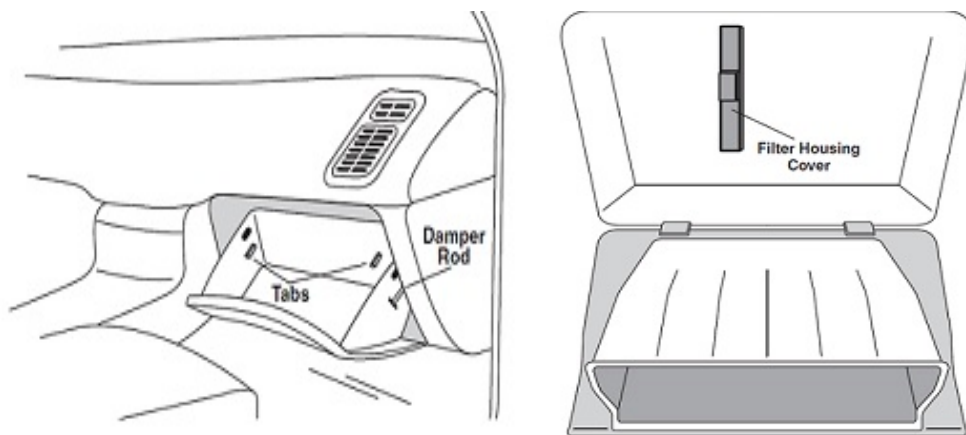

This is only a guide and may not be for exact model. See Owner's manual and/or local mechanic for exact instructions for the particular model.