

CABIN AIR FILTER – INSTALLATION INSTRUCTIONS

Part No.: PC5644X

Est. Installation Time: less than 20 mins

Pontiac OE: 88970273; Toyota OE: 87139-YZZ09; Dodge OE: 68164981AA

The Cabin air filter is located behind the glove compartment

- Open the glove box
- Slide off the damper rod on the right side of the glove box. Fig. 1. (The damper might be secured with a screw in some models, remove the screw first – Fig. 2)
- Remove the stoppers on both sides to allow the glove box to hang freely on the hinges
- Open the cabin filter door by unlatching the two latches at the top of the door and allow the door to swing downward (Fig 3)
- Remove the old cabin air filter, taking note the air flow arrow indicator on the side of the old filter
- Insert the new filter into the assembly, making sure the air flow direction is correct according to the arrow indicator
- Replace the rest of the glove box assembly by reversing the removal procedure

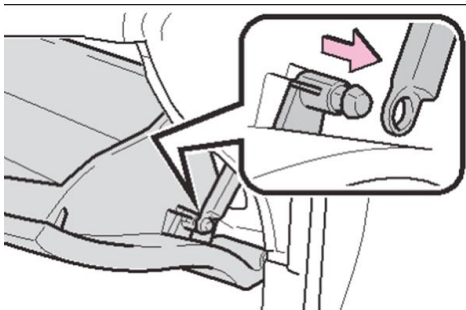

Figure 1

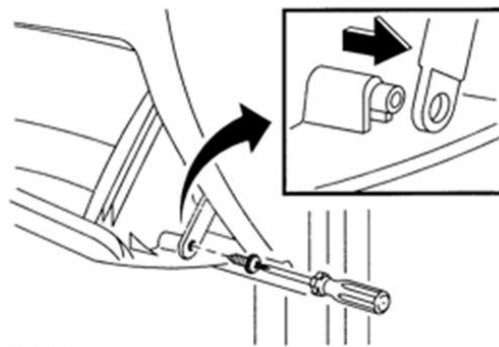

Figure 2

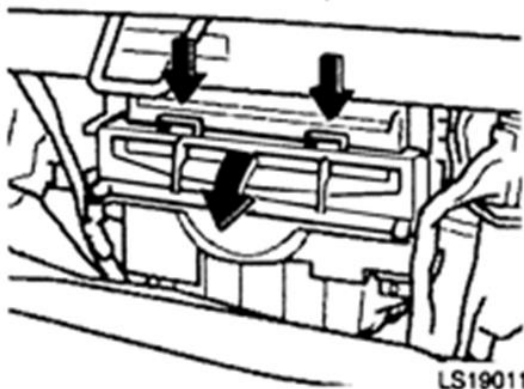

Figure 3

This is only a guide and may not be for exact model. See Owner's manual and/or local mechanic for exact instructions for the particular model.