

CABIN AIR FILTER – INSTALLATION INSTRUCTIONS

Item No.: **PC5518X**

Est. Installation Time: **less than 15 min.**

Lexus GS300, 430 (2001-05), LS430 (2001-06), SC430 (2002-10) OEM No. 87139-50030

1. The filter is located behind the glove box.
2. Turn the "POWER" switch to OFF. Open the glove box. Lift and remove the partition. See step 2

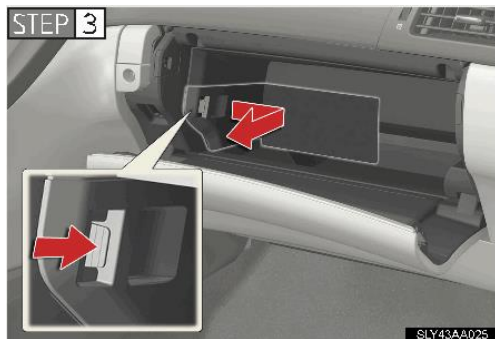
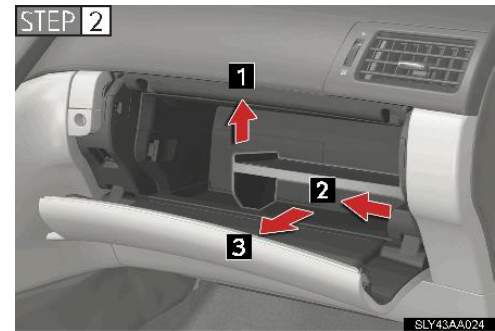

Locating Glove Box Partition Remove glove box cover. See step 3

6.

4. Remove filter housing cover by pressing it to the left and pulling it out - see step 4 (some applications by pressing upon the two latches along the bottom edge and then pull the cover away)
5. Slide and pull out the filter - step 5 (some applications will have filter frame inside the housing. Drop the frame down and then pull it out of the housing)
6. Remove the old filter from the frame.
7. Replace the filter with a new one. The "UP" mark on the filter should be pointing up. See step 5

