

CABIN AIR FILTER – INSTALLATION INSTRUCTIONS

Part No.: **PC5479X**

Est. Installation Time: **less than 15 mins**

Toyota OE: 87139-06030, 88880-41010, 87139-YZZ19

The Cabin air filter is located behind the glove compartment

- Open the glove box
- Remove the Phillips head screw which is located on the right side of the glove box connecting the dampener arm (Fig 1)
- Push each side of the glove box to disconnect the claws and allow the glove compartment to swing freely down towards the floorboard on its bottom hinge (Fig 2)
- Pull the filter frame straight out from the housing (Fig 3)
- Remove the old cabin air filter, taking note the air flow arrow indicator on the side of the old filter
- Insert the new filter into the assembly, making sure the air flow direction is correct according to the arrow indicator (Fig 4)
- Replace the rest of the glove box assembly by reversing the removal procedure

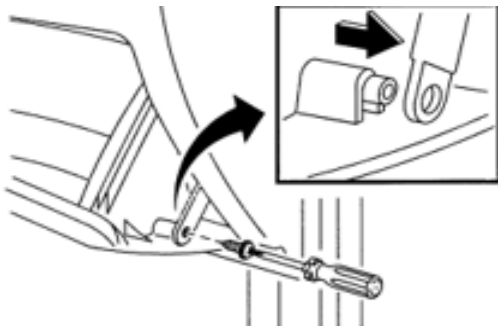

Figure 1



Figure 2

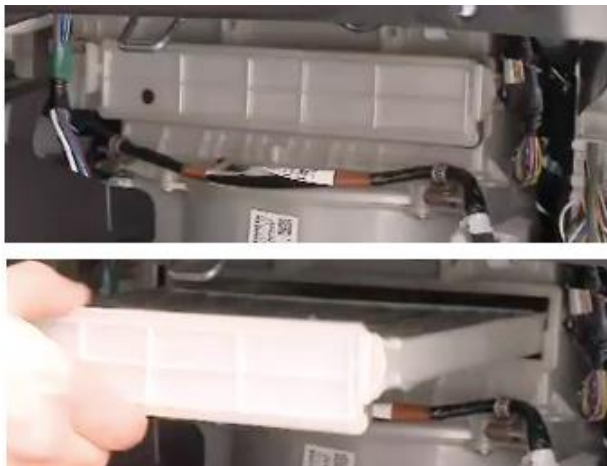

Figure 3



Figure 4

This is only a guide and may not be for exact model. See Owner's manual and/or local mechanic for exact instructions for the particular model.