

CABIN AIR FILTER – INSTALLATION INSTRUCTIONS

Est. Installation Time: less than 15 min.

The Cabin Air Filter is located behind the glove box.

1. Remove 2 upper screws on glove box and carefully pry metal clips loose. See exploded View of Glove Box
2. Do not let glove box assembly hang from glove box lamp harness.
3. Disconnect glove box lamp electrical connector.
4. Remove 3 lower screws and remove damper clip from glove box door.
5. Separate glove box housing and passenger instrument lower panel.
6. Remove 3 screws and remove cabin air filter cover.
7. Remove all filter and clean the filter housing
8. Make sure to insert 2 new cabin air filters ensure that the filters are facing in the direction indicated by the direction arrow for the air flow. Direction arrow is printed on side of cabin air filters.

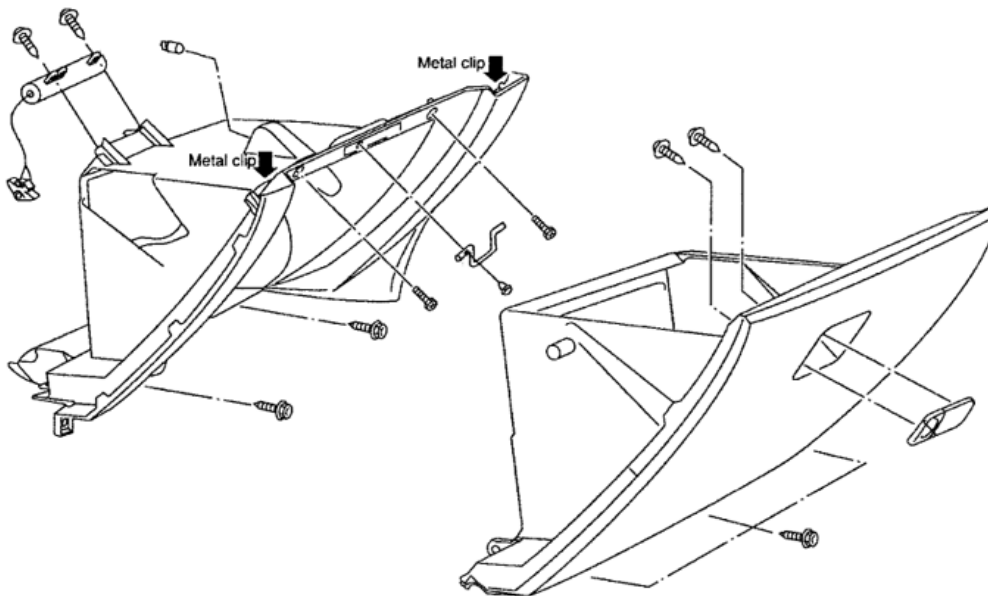

This is only a guide and may not be for exact model. See Owner's manual and/or local Technician for exact instructions for the particular model.