

CABIN AIR FILTER – INSTALLATION INSTRUCTIONS

Item No.: **PC4855HX**

Est. Installation Time: **less than 20 min.**

Nissan Quest (2004-09) OEM No. 27299-5Z000

1. Remove 2 upper screws on glove box and carefully pry metal clips loose. See exploded View of Glove Box
2. Do not let glove box assembly hang from glove box lamp harness.
3. Disconnect glove box lamp electrical connector.
4. Remove 3 lower screws and remove damper clip from glove box door.
5. Separate glove box housing and passenger instrument lower panel.
6. Remove 3 screws and remove cabin air filter cover.
7. Remove all filter and clean the filter housing
8. Make sure to insert 2 new cabin air filters ensure that the filters are facing in the direction indicated by the direction arrow for the air flow. Direction arrow is printed on side of cabin air filters.

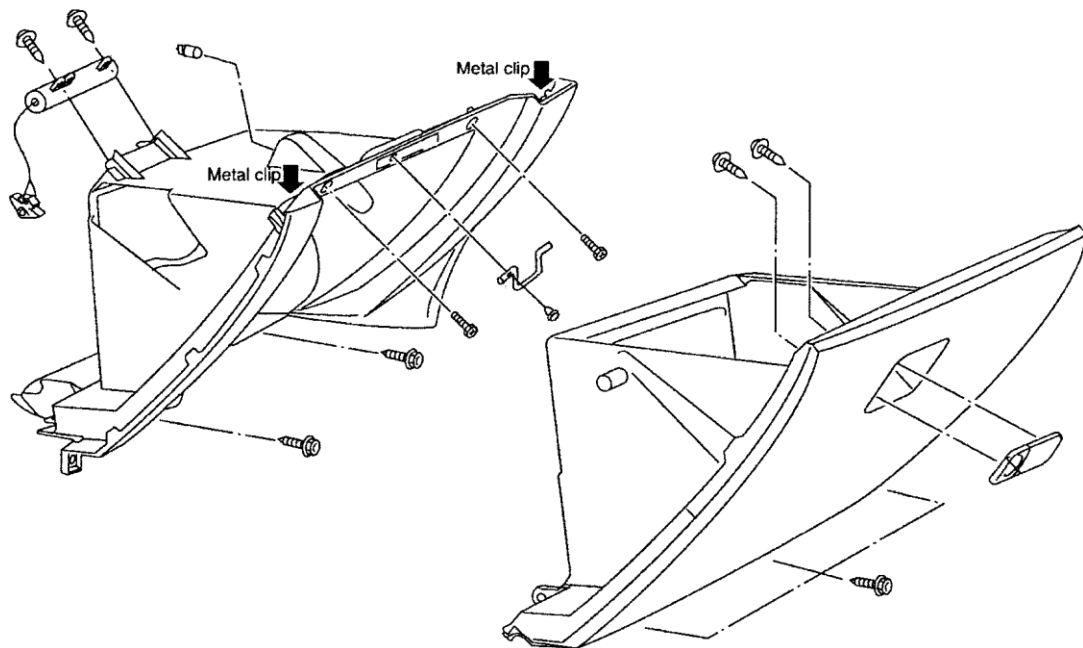

G00299404